

## MILLENNIUM SEOUL HILTON BANQUET FACILITIES

| Meeting Room             | Dimensions        |                   |        |       |       | Capacity |           |           |         |
|--------------------------|-------------------|-------------------|--------|-------|-------|----------|-----------|-----------|---------|
|                          | Feet              | Meters            | Sq.ft. | Sq.m. | Pyong | Banquet  | Reception | Classroom | Theatre |
| <b>Lower Lobby Level</b> |                   |                   |        |       |       |          |           |           |         |
| <b>Grand Ballroom</b>    | 126 × 75 × 23     | 38.4 × 22.9 × 6.9 | 9,450  | 879   | 263   | 450      | 700       | 450       | 700     |
| Section A                | 50 × 75 × 23      | 15.2 × 22.9 × 6.9 | 3,750  | 348   | 105   | 120      | 200       | 120       | 250     |
| Section B                | 25 × 75 × 23      | 7.7 × 22.9 × 6.9  | 1,875  | 176   | 53    | 80       | 120       | 80        | 150     |
| Section C                | 50 × 75 × 23      | 15.2 × 22.9 × 6.9 | 3,750  | 348   | 105   | 120      | 200       | 120       | 250     |
| Section AB               | 75 × 75 × 23      | 22.9 × 22.9 × 6.9 | 5,625  | 524   | 158   | 200      | 320       | 200       | 400     |
| Section BC               | 75 × 75 × 23      | 22.9 × 22.9 × 6.9 | 5,625  | 524   | 158   | 200      | 320       | 200       | 400     |
| Foyer                    | 102 × 26 × 14     | 31.3 × 7.8 × 4.2  | 2,652  | 244   | 74    | -        | 200       | -         | -       |
| <b>Junior Ballroom</b>   | 72 × 40 × 12      | 21.9 × 12.1 × 3.6 | 2,880  | 265   | 81    | 100      | 150       | 120       | 180     |
| Section A                | 24 × 40 × 12      | 7.3 × 12.1 × 3.6  | 960    | 88    | 27    | 40       | 60        | 40        | 60      |
| Section B                | 24 × 40 × 12      | 7.3 × 12.1 × 3.6  | 960    | 88    | 27    | 40       | 60        | 40        | 60      |
| Section C                | 24 × 40 × 12      | 7.3 × 12.1 × 3.6  | 960    | 88    | 27    | 40       | 60        | 40        | 60      |
| Section AB               | 48 × 40 × 12      | 14.6 × 12.1 × 3.6 | 1,920  | 176   | 54    | 60       | 80        | 60        | 80      |
| Section BC               | 48 × 40 × 12      | 14.6 × 12.1 × 3.6 | 1,920  | 176   | 54    | 60       | 80        | 60        | 80      |
| <b>Rialto</b>            | 41.7 × 23.6 × 12  | 12.7 × 7.2 × 3.6  | 984    | 91    | 27.5  | 40       | 60        | 30        | 50      |
| Section A                | 20.9 × 23.6 × 12  | 6.4 × 7.2 × 3.6   | 493    | 46    | 13.75 | 20       | 30        | 15        | 25      |
| Section B                | 20.9 × 23.6 × 12  | 6.4 × 7.2 × 3.6   | 493    | 46    | 13.75 | 20       | 30        | 15        | 25      |
| <b>3rd Floor</b>         |                   |                   |        |       |       |          |           |           |         |
| <b>Amber</b> 앰버          | 20 × 37.1 × 9.1   | 6.1 × 11.3 × 2.8  | 742    | 69    | 22.8  | 40       | 50        | 30        | 50      |
| <b>Topaz</b> 토파즈         | 19.7 × 51.2 × 8.5 | 6.0 × 15.6 × 2.6  | 1,009  | 94    | 28.4  | 50       | 60        | 40        | 60      |
| <b>Coral</b> 코랄          | 18.3 × 72.8 × 9.1 | 5.6 × 22.2 × 2.8  | 1,332  | 124   | 40.5  | 60       | 80        | 50        | 80      |
| Section A                | 18.3 × 23.6 × 9.1 | 5.6 × 7.2 × 2.8   | 432    | 40    | 13.5  | 20       | 25        | 12        | 25      |
| Section B                | 18.3 × 25.6 × 9.1 | 5.6 × 7.8 × 2.8   | 468    | 44    | 13.5  | 20       | 25        | 12        | 25      |
| Section C                | 18.3 × 23.6 × 9.1 | 5.6 × 7.2 × 2.8   | 432    | 40    | 13.5  | 20       | 25        | 12        | 25      |
| Section AB               | 18.3 × 49.2 × 9.1 | 5.6 × 15 × 2.8    | 900    | 84    | 27    | 50       | 60        | 40        | 60      |
| Section BC               | 18.3 × 49.2 × 9.1 | 5.6 × 15 × 2.8    | 900    | 84    | 27    | 50       | 60        | 40        | 60      |
| <b>Jade</b> 제이드          | 30.5 × 38.7 × 7.8 | 9.3 × 11.8 × 2.4  | 1,013  | 110   | 27    | 50       | 60        | 40        | 60      |
| Section A                | 30.5 × 19.0 × 7.8 | 9.3 × 5.8 × 2.4   | 468    | 54    | 13.5  | 20       | 30        | 20        | 30      |
| Section B                | 30.5 × 19.6 × 7.8 | 9.3 × 6.0 × 2.4   | 513    | 56    | 13.5  | 20       | 30        | 20        | 30      |

# Grand Ballroom (Lower Lobby)

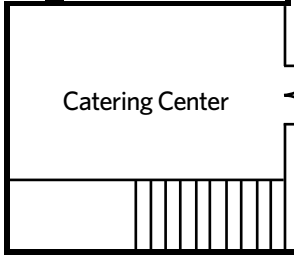
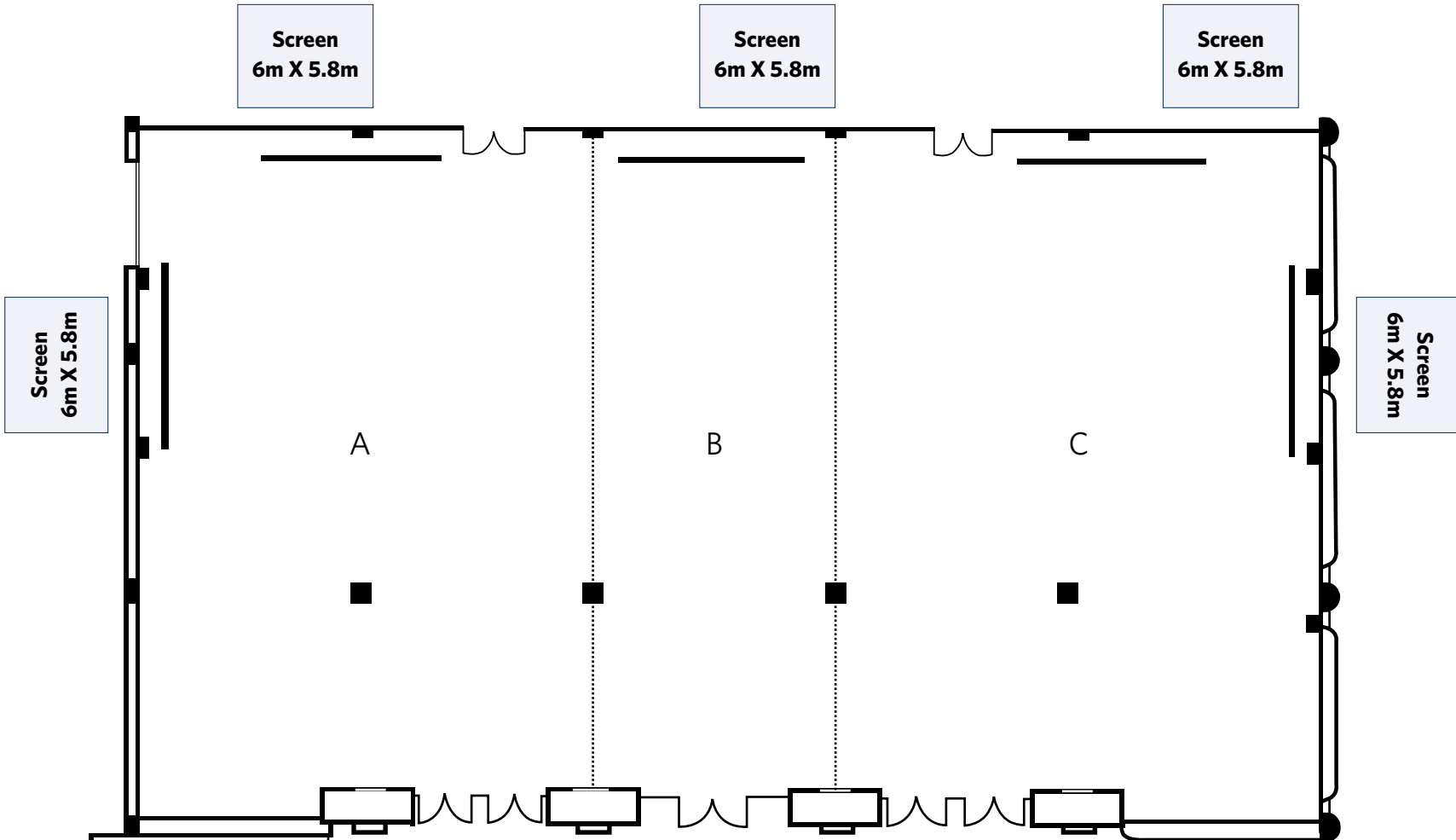

| Meeting Room              | Feet      | Meter         | Sq.ft | Sq.m |
|---------------------------|-----------|---------------|-------|------|
| <b>Grand Ballroom ABC</b> | 126X75X23 | 38.4X22.9X6.9 | 9,450 | 879  |
| Section A                 | 50X75X23  | 15.2X22.9X6.9 | 3,750 | 348  |
| Section B                 | 25X75X23  | 7.7X22.9X6.9  | 1,875 | 176  |
| Section C                 | 50X75X23  | 15.2X22.9X6.9 | 3,750 | 348  |
| Foyer                     | 102X26X14 | 31.3X7.8X4.2  | 2,652 | 244  |

Baton Size : 7.2m  
Banner Size : 7m x 0.9m

**Junior Ballroom** (Lower Lobby)

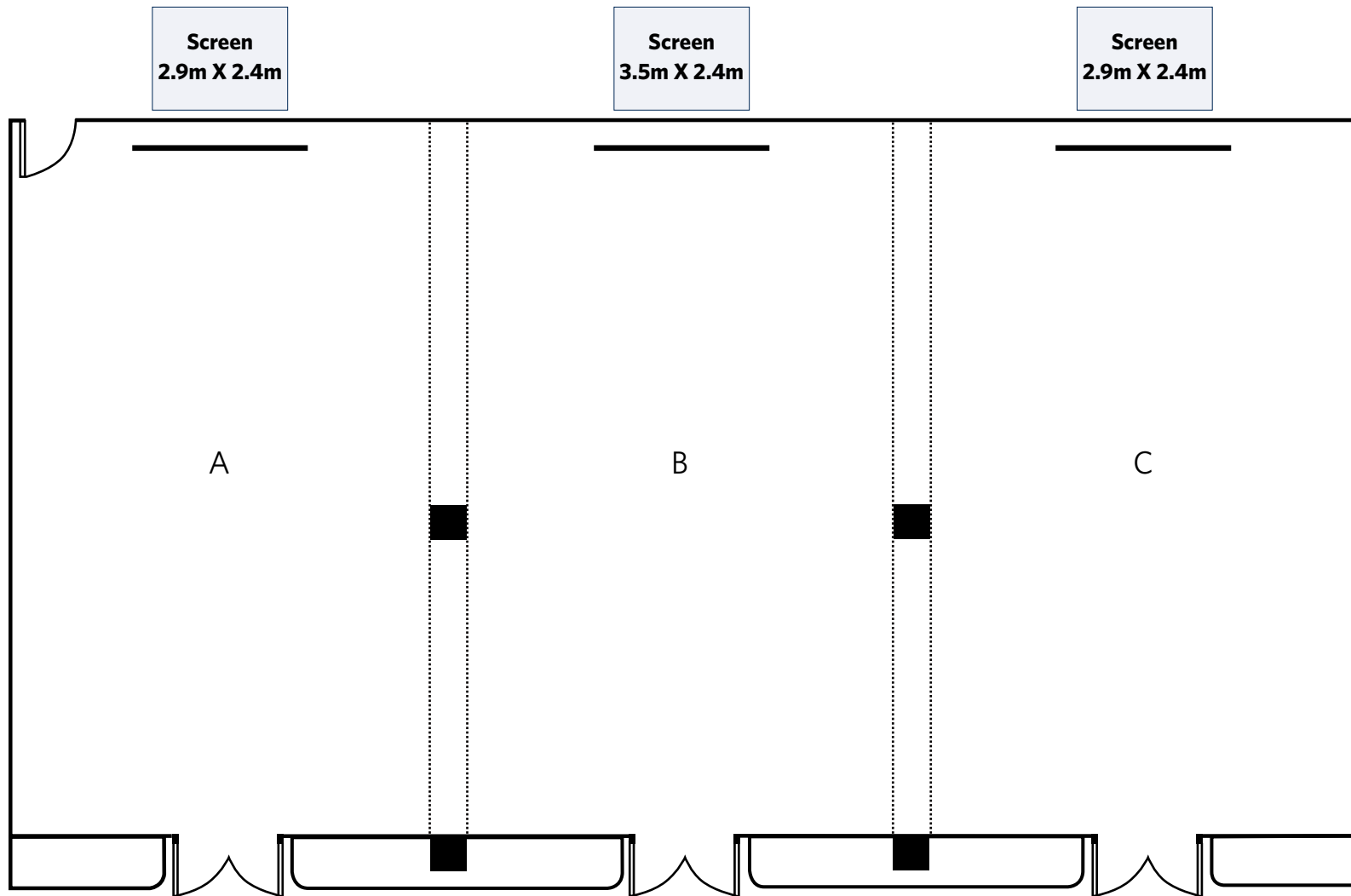

| Meeting Room        | Feet      | Meter         | Sq.ft | Sq.m |
|---------------------|-----------|---------------|-------|------|
| Junior Ballroom ABC | 72X40X12  | 21.9X12.1X3.6 | 2,880 | 265  |
| Section A           | 24X40X12  | 7.3X12.1X3.6  | 960   | 88   |
| Section B           | 24X40X12  | 7.3X12.1X3.6  | 960   | 88   |
| Section C           | 24X40 X12 | 7.3X12.1X3.6  | 960   | 88   |

Banner Size : 6m x 0.9m

**Coral** (3rd Floor)

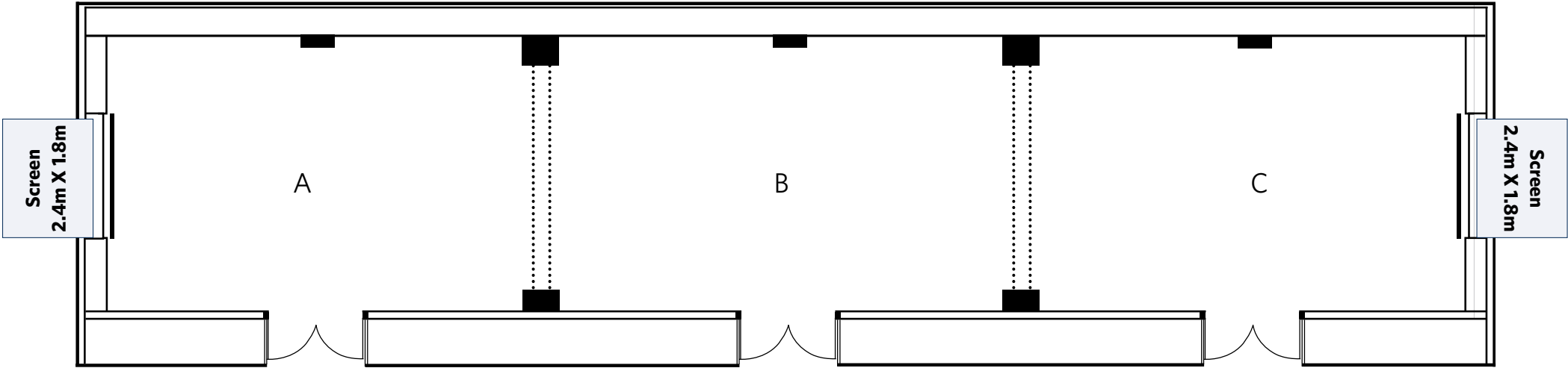

| Meeting Room | Feet          | Meter        | Sq.ft | Sq.m |
|--------------|---------------|--------------|-------|------|
| Coral A B C  | 18.3X72.8X9.1 | 5.6X22.2X2.8 | 1,332 | 124  |
| Section A    | 18.3X23.6X9.1 | 5.6X7.2X2.8  | 432   | 40   |
| Section B    | 18.3X25.6X9.1 | 5.6X7.8X2.8  | 468   | 44   |
| Section C    | 18.3X23.6X9.1 | 5.6X7.2X2.8  | 432   | 40   |

Banner Size : 5m x 0.9m

**Topaz** (3rd Floor)

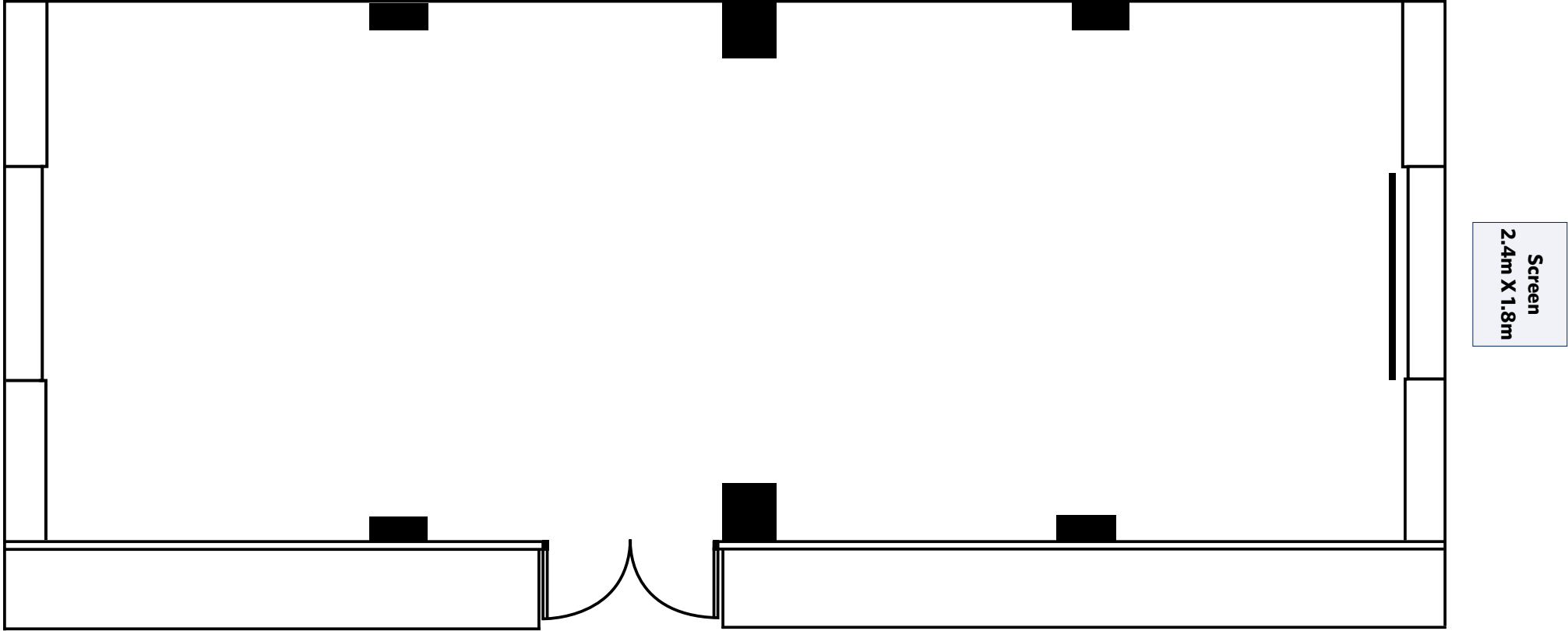

| Meeting Room | Feet          | Meter        | Sq.ft | Sq.m |
|--------------|---------------|--------------|-------|------|
| Topaz        | 19.7X51.2X8.5 | 6.0X15.6X2.6 | 1,009 | 94   |

Banner Size : 5m x 0.9m

**Jade** (3rd Floor)

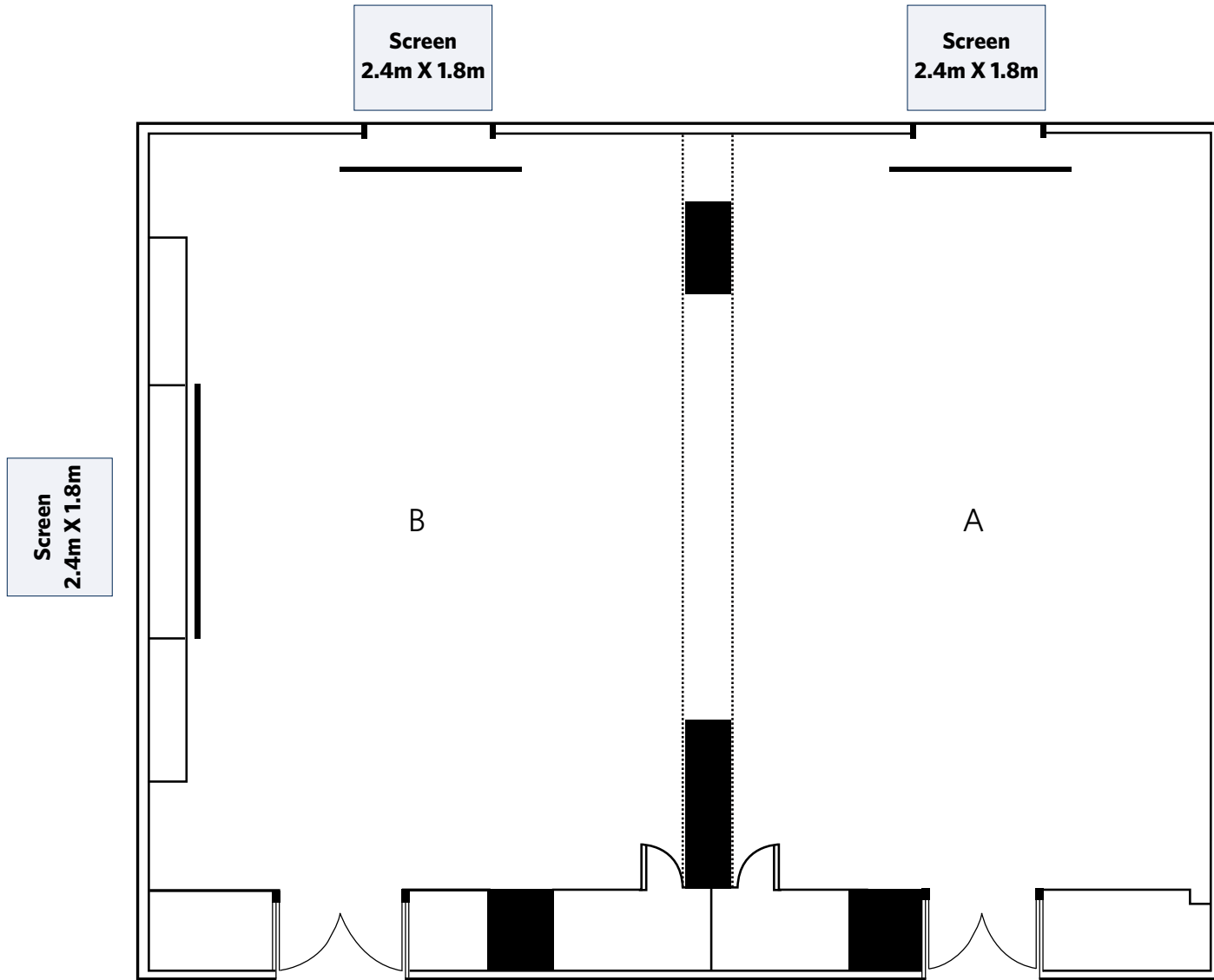

| Meeting Room | Feet          | Meter        | Sq.ft | Sq.m |
|--------------|---------------|--------------|-------|------|
| Jade AB      | 30.5X38.7X7.8 | 9.3X11.8X2.4 | 1,013 | 110  |
| Section A    | 30.5X19.0X7.8 | 9.3X5.8X2.4  | 468   | 24   |
| Section B    | 30.5X19.6X7.8 | 9.3X6.0X2.4  | 513   | 56   |

Banner Size : 5m x 0.9m

**Amber** (3rd Floor)

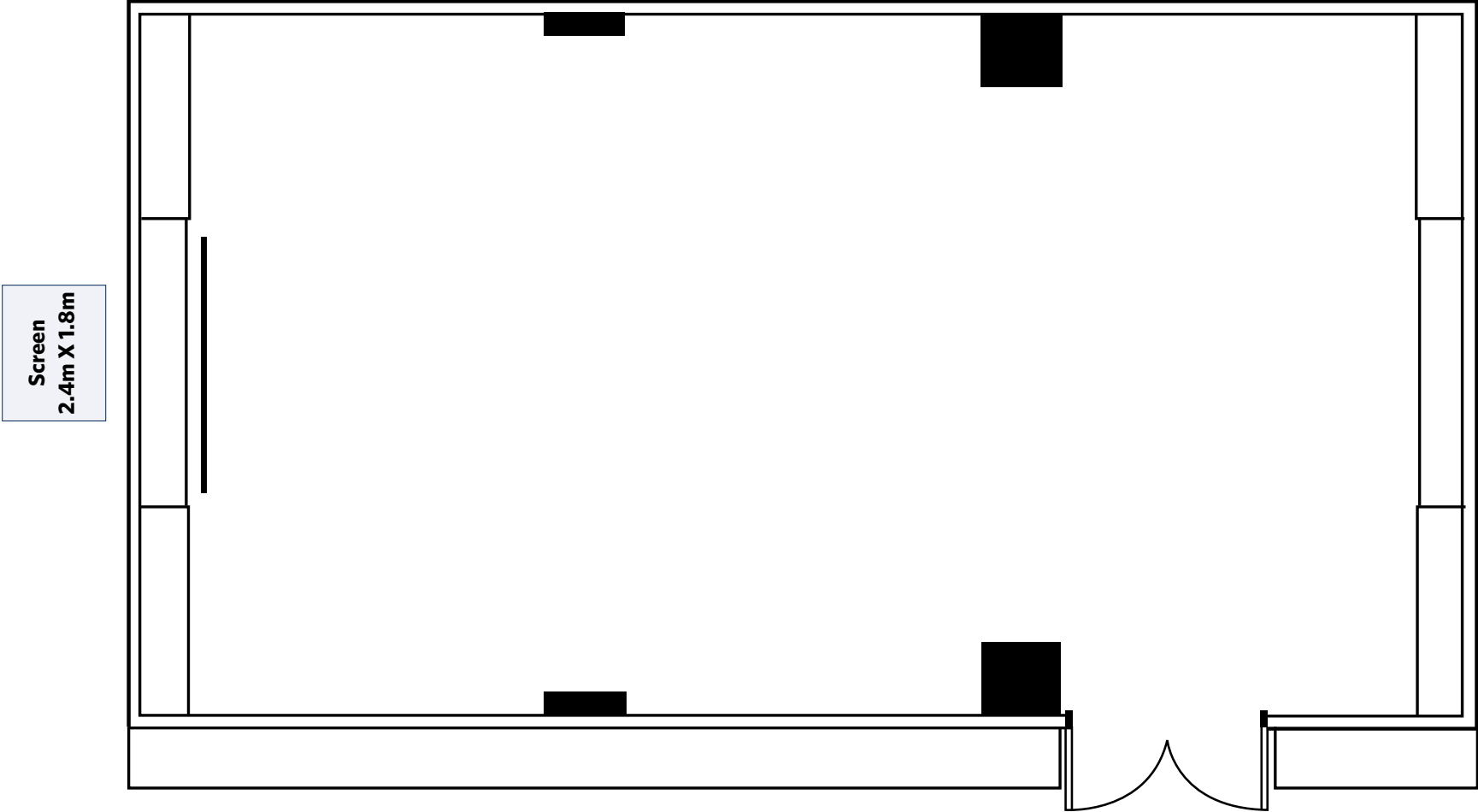

| Meeting Room | Feet        | Meter        | Sq.ft | Sq.m |
|--------------|-------------|--------------|-------|------|
| Amber        | 20X37.1X9.1 | 6.1X11.3X2.8 | 742   | 69   |

Banner Size : 5m x 0.9m