



你的
会议 值得希尔顿
全力以赴

Your Convention Deserves Hilton Attention



苏州希尔顿酒店
Hilton Suzhou

中国江苏省苏州市工业园区苏州大道东275号, 邮编215028
No.275 Suzhou Avenue East, Industrial Park, Suzhou, Jiangsu Province, China, 215028
电话 T: +86(512) 6292 8888 传真 F: +86(512) 6292 8889





你的会议值得希尔顿全力以赴

-Your Convention Deserves Hilton Attention

苏州希尔顿酒店坐落于苏州新加坡工业园区中心地段，地铁1号线与酒店大堂无缝连接。酒店由357间客房以及181间长住套房组成，200个停车位，拥有1,008平方米挑高7.5米的无柱大宴会厅，以及毗邻酒店2,000平方米，层高达18米的演播厅，为商务及休闲的客人提供完善、完美的下榻之所。

Hilton Suzhou located in the CBD of Suzhou Industrial Park, close to Nanshi Street Station on Metro Line 1, which connects directly to the hotel lobby. Hotel consists of 357 guest rooms and 181 suites, 200 parking lot, with 1,008 m² pillar-less Grand Ballroom and 2,000 square meters adjoining studio with 18 meter-high-ceiling. Let our professional team take care of the details, ensuring your event is a success.



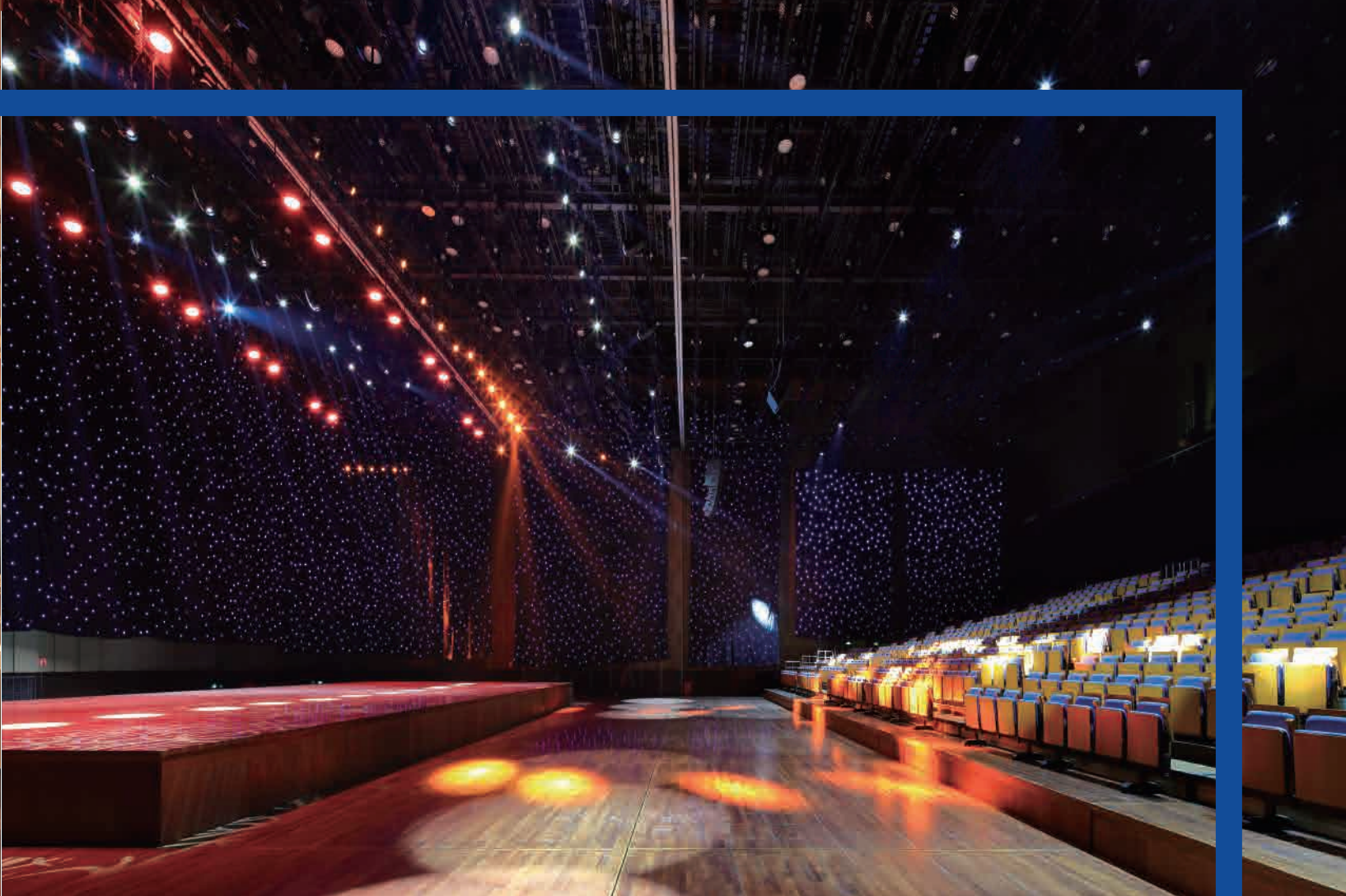

周到 | Thoughtful

- 1,008平方米，层高7.5米的无柱大宴会厅，可灵活分割成3个小宴会厅。
- 380平方米的大宴会厅前厅，层高7.5米，是举办各种酒会的理想场所。
- 9个多功能会议室，有充沛的自然光线。
- 提供先进的视听设备租赁、液晶投影仪、高速宽带和无线互联网接入、24小时商务中心服务及传真、打印等服务。
- 1,008 square meters pillar-less Grand Ballroom with 7.5 meter-high-ceiling.
- 380 square meters Ballroom Foyer with 7.5 meter-high-ceiling is an ideal place for hosting cocktail party.
- 9 Function Rooms enhanced with natural daylight.
- Multi-purpose equipment and facilities available for various event needs, including LED projectors, high-speed broadband and WI-FI, 24 hour Business Center, facsimile service and printing and copying service.

- 毗邻酒店2,000平方米，层高达18米的演播厅，是您在苏州举办各种大型会议或高端活动的最佳地点。
- 2,000 square meters adjoining studio with 18 meter-high-ceiling is perfect choice for conference and event.





会议包价 | Meeting Packages

针对30人以上的团队推出的会议包价

全天会议包价: 人民币 458+15%服务费每位起

半天会议包价: 人民币 358+15%服务费每位起

包含:

- 8小时或4小时会议室使用
- 会议所需的标准文具、瓶装水和薄荷糖
- 会议所需标准视听设备 (包含一台投影仪)
- 上午/下午茶歇提供, 包含咖啡、茶、精选点心及水果
- 一次自助午餐或一次中式圆桌餐
- 会议期间免费提供电子指示牌或立式指示牌
- 会议期间免费使用会议室网络
- 会议期间提供全程专业会议服务人员

Meeting Packages are available for groups with a minimum of 30 people

Full-Day Meeting Package: RMB 458+15% service charge per person

Half-Day Meeting Package: RMB 358+15% service charge per person

Including:

- An uninterrupted 8 hours or 4 hours meeting in one of meeting room
- Use of standard stationery, bottled water and mints
- Standard audio visual equipment (Include 1 set of LCD projector)
- Morning /afternoon coffee break, including coffee, tea, selected dessert and fresh fruit
- One buffet lunch or one round table dinner
- Use of electronic signage or directional signage
- Wired and wireless internet accesses during meeting
- Dedicated conference butler throughout your meeting



宴会茶歇 | Banquet Coffee Break

人民币68元/位起 (另加15%服务费)
RMB 68.00/Person (plus 15% service charge)

人民币78元/位起 (另加15%服务费)
RMB 78.00/Person (plus 15% service charge)

人民币98元/位起 (另加15%服务费)
RMB 98.00/Person (plus 15% service charge)

主题茶歇 | Theme Coffee Break

精点系列 Retail

西式经典 Best Western



舒心 | Comfortable

客房房型	Room Type	面积 Size (m ²)	大床 King (1.8m x 2m)	双床 Twin (1.35m x 2m)	总数 Total
高级房	Guest Room	40	84	121	139
豪华房	Deluxe Room	48	22	0	121
行政房	Executive Room	40	50	24	74
希尔顿套房	King Suite	77	15	0	15
豪华套房	King Deluxe Suite	117	3	0	3
总统套房	Presidential Suite	197	1	0	1
无障碍套房	Accessible Room	40	4	0	4
-	-	-	212	145	357

所有房型均可加床 (1.1m x 2m), 总共加床数30张。

长住套房房型	Room Type	面积 Size (m ²)	总数 Total
精致套房	Studio	54	54
一室套	One Bedroom Suite	63	42
豪华一室套	Deluxe One Bedroom Suite	82	58
两室套	Two Bedroom Suite	122	11
豪华两室套	Deluxe Two Bedroom Suite	162	2
三室套	Three Bedroom Suite	158	12
豪华三室套	Deluxe Three Bedroom Suite	181	2
-	-	-	181

所有房型均可加床 (1.1m x 2m), 总共加床数30张。



珍馐 | Dainties



OPEN全日餐厅

OPEN全日餐厅精选优质食材，以现代手法呈现经典亚洲菜肴、西式风味烧烤以及时令肥美海鲜。富有艺术感的细节装饰，开放式空间以及互动厨房打造精致、友好的用餐氛围，让你全天候品味舌尖精彩，每一口都尽享风味。

OPEN All-day Dining Restaurant

OPEN is an all-day restaurant that fuses food cultures from the east and west. From classic Asian cuisine, western-style grills to freshly prepared seafood, every bite is a custom-made feast for the taste buds. The open plan and inventive interior design, plus a kitchen space that sparks interaction with guests creates a sophisticated yet friendly leisure ambience.



御玺中餐厅

在鱼米之乡苏州，请尽情享受大自然的美好恩赐。御玺选用苏州当地的天然、时令食材，遵循传统烹饪方法，精心打造中式经典菜肴。从江苏名菜北京烤鸭到广式滋补靓汤，足不出户也能一一品尝。高雅的餐厅氛围和私密的贵宾包间设计，御玺是亲友欢聚和商务洽谈的理想用餐之地。

YUXI Chinese Restaurant

YUXI is a culturally rich symbol: the special seal held by the emperor of China. YUXI restaurant grants you the essence of Chinese food cultures. Lying on the coast of China, Suzhou is a land of plenty. YUXI selects only the best seasonal produce and follows the traditional wisdom of China to present classic dishes. From Beijing Roast Duck to Canton's signature "Nourishing Soup", the flavours of China are presented in an elegant family and business space.



BACIO意大利餐厅

BACIO在意大利语中有“吻”之意。这里的每一道菜品都是“精雕细琢的意大利风味”。星级进口牛排、遵循意式传统烤制的披萨、口感劲道的手工意面——在有着“东方威尼斯”美誉的苏州，品尝由精选进口食材制作而成的地道意大利菜肴，自然别有一番滋味。半开放式的厨房，更让您全程目睹美味出炉，惊喜连连。

BACIO Italian Restaurant

BACIO, a "kiss" in Italian, could only be set within the romantic scenes of Suzhou, the 'Venice of the East'. Our Italian restaurant features a traditional pizza oven and authentic methods of Italian cooking. With all-imported produce, BACIO offer star-quality steak, the freshest pizza and tantalizing pasta. An unpretentious and rustic interior with open-plan kitchen ensures appreciate the passion our chefs put into each dish.



啤酒荟

啤酒荟搜罗世界各地啤酒精酿并分区独立呈现，让宾客感受酣畅淋漓的啤酒畅饮体验。配备先进的试听设备，并有乐队现场助兴，在啤酒会，宾客还能身临其境一般，近距离追踪、观赏热点赛事——开怀尽兴，愉悦度过旅途之中每一个好友相伴的活力之夜。

Beer Society

Sports Bar is perfect place to rest and enjoy the essence of sports and games. A suitable sports bar does offer a sporting environment to customers. With 60 seats available. This combination of live sports and delicious food will surely give a pleasure and memorabilia experience.



园大堂吧

在“园”大堂酒廊，等待您的是舒适与轻松休闲的时光，我们均选用优质上品原材料，制作出品种多样、精致可口的甜点茶饮供您品尝享用。

YUAN Lobby Bar

Come to YUAN and enjoy our leisure time. What awaits you are heavenly delights and relaxing teatime ambience, we'll pamper you with an extensive variety of dainty refreshments, all made with premium ingredients.



焕活 | Refresh

泳池

在我们的泳池里享受游泳的乐趣，或者在池畔品享沁心冷饮，尽情放松身心。泳池区提供毛巾。16周岁以下的儿童须有成人陪同才能游泳。

Swimming Pool

For recreation, enjoy swimming in our pool or relax with a cool beverage. Towels are provided in the pool area. Children under the age 16 are required to swim with a supervising adult.

健身中心

在旅途中享受定制健身服务，打造平衡的生活方式。希尔顿健身中心配有新一代有氧和力量训练设备，为您打造定制健身方案，让您找到更好的自己。

Fitness Center

Personalized fitness for a balanced lifestyle while on the road. Featuring the latest generation of cardio and strength training equipment, Hilton Fitness Center takes a personalized approach to help you feel your best.

儿童俱乐部

让您的孩子在我们的儿童俱乐部开心玩耍。我们还准备了儿童绘画工具，同时全天播放卡通和电影。

Kid's Club

Let your kids find their own groove at Kid's Club. We also have painting sets for kids, and show cartoon and movies all day.

水疗中心

我们的水疗中心提供面部护理、按摩、理疗泡澡等众多美容美体服务，让您彻底放松身心，重焕神采。

SPA

To give you a break and take care of your beauty and body needs, our Spa will rejuvenate and relax you with refreshing facial treatments, massages, therapy baths and more.

探索 | Discovery



斜塘老街 (1.5公里)

斜塘老街位于苏州工业园区金鸡湖东斜塘河畔，是一个以文化旅游为特色，具有浓郁江南水乡家园记忆和人文情怀的商业街区。

Xietang Street (1.5km)

Xietang street is located in the Suzhou Industrial Park Xietang River with rich Jiangnan region of rivers and lakes home memories and humanistic feelings of the commercial district.



苏州诚品书店 (2公里)

苏州诚品书店是台湾诚品书店在大陆的第一家分店。位于苏州工业园区金鸡湖东畔，集结文化、表演、艺术、商业、观光，是一个具有跨界综效性的创意平台。

Eslite (2km)

Taiwan's Eslite Bookstore opened its first branch on the mainland, in Suzhou. It located in east of Jinji Lake, what Eslite has built in Suzhou is not only a bookstore but also a shopping complex, and also contain galleries and spaces for other art forms.



苏州国际博览中心 (3公里)

苏州国际博览中心占地面积18.86万平方米，总设计建筑面积25.5万平方米，拥有世界一流水平的配套设施，功能齐全，布局合理，可承接国际、国内大型展览会、会议和活动，可提供世界上最大的不间断展览空间。

Suzhou International Expo Center (3km)

Suzhou International Expo Center located in the main area of comprehensive business center in Suzhou Industrial Park which covers an area of 188.6 thousand square meters, it's a complex of exhibitions, conferences, events, business service, catering and entertainment etc.



苏州摩天轮主题公园 (3公里)

摩天轮，高120米，是目前国内最大的水上摩天轮。它拥有瑞士进口的60个吊舱，可同时容纳360人观光，从摩天轮上俯瞰园区，将会呈现别样风情。

Suzhou Ferris Wheel Theme Park (3km)

It is built by the Suzhou Jinji Lake and ranked as the biggest domestic ferris wheel on water. The ferris wheel owns 60 booths and can contain 360 visitors for sightseeing.



苏州博物馆 (9.5公里)

苏州博物馆是地方历史艺术性博物馆。1960年建立，位于苏州市东北街。馆址为太平天国忠王李秀成王府遗址。2006年10月建成新馆，设计者为著名的建筑设计大师贝律铭。

Suzhou Museum (9.5km)

Suzhou Museum is a museum of ancient Chinese art, ancient Chinese paintings, calligraphies, and handmade crafts, situated in Suzhou, Jiangsu, People's Republic of China. Most are ancient paintings and calligraphy, ceramics, crafts, unearthed relics and revolution relics.



拙政园 (10公里)

拙政园始建于明正德初年(16世纪初)，距今已有500多年历史，是江南古典园林的代表作品。1961年被国务院列为全国第一批重点文物保护单位，与同时公布的北京颐和园、承德避暑山庄、苏州留园一起被誉为中国四大名园。

Humble Administrator's Garden (10km)

Humble Administrator's Garden is representative of Chinese classical gardens in the Ming Dynasty, which are focused on a central pond with pavilions. The structures are grouped round a labyrinthine lake, rather like a Chinese water village. The garden consists of Eastern, Central and Western sections as well as some residences of the former owners.

希尔顿荣誉客会 | Hilton Honors

领取积分，走向梦幻天堂

最丰富的积分使用方式，让您乐享长周末或更长时间的逍遥之旅。通过我们酒店和合作伙伴赚取积分，享受积分兑换的奖励，例如免费酒店住宿。但这仅仅只是开始。扫码下方二维码，尽情探索希尔顿荣誉客会积分能带给您的所有惊喜。

Follow Your Points to Your Paradise

For long weekends or longer escapes, no one offers more ways to use Points. Earn Points with our hotels and partners, then use your Points for rewards, like free hotel stays. But that is only the beginning. Explore all the things that are possible with Hilton Honors Points below.

积分赚取，方法多多

当您成为希尔顿荣誉客会会员之后，入住希尔顿品牌组合旗下酒店及度假村，即可赚取希尔顿荣誉客会积分。无论您在何处，只要您通过我们的合作伙伴旅游、购物、就餐或消费，均有机会赚取希尔顿荣誉客会积分。从航空公司和租车行到信用卡和葡萄酒俱乐部，希尔顿荣誉客会在世界各地拥有成百上千的合作伙伴——每个合作伙伴都是您赚取更多希尔顿荣誉客会积分的另一次机会。

A Million Ways to Earn Points

When you become a Hilton Honors Member, you earn Hilton Honors Points for staying at hotels and resorts within the Hilton Portfolio. You also earn Hilton Honors Points whenever you travel, shop, dine or spend with our partners. From airlines and car rentals to credit cards and wine clubs, Hilton Honors has hundreds of partners around the world – and each one is another opportunity to earn more Hilton Honors Points.

积分无尽使用，挥洒难忘记忆

丰富多样的积分使用方式，比其它顾客忠诚计划更胜一筹。将您的希尔顿荣誉客会积分转化为在全球4,800多家酒店及度假村享受令您情不自禁的非凡体验。奖励包括无积分禁用日期的免费住宿——您甚至可以用积分预订我们最豪华的套房。您还可以通过我们的旅行、购物、餐饮和娱乐合作伙伴兑换希尔顿荣誉客会积分，享受卓越服务。

Unforgettable Ways to Use Them

No other guest loyalty program offers more ways to use Points. Transform your Hilton Honors Points into experiences you can not help but share at more than 4,800 hotels and resorts worldwide. Rewards include free nights with no blackout dates – you can even use Points to book our most luxurious suites. You can also redeem Hilton Honors Points with our travel, shopping, dining and entertainment partners.

活动奖励计划

- 1、会员在希尔顿全球酒店集团所属酒店(不包括美国及加拿大地区)的举办认可活动，每消费1美元可赚取1点荣誉客会奖励积分和1英里航空里程，或每消费1美元赚取1.5点荣誉客会奖励积分。
- 2、认可费用包括由此协议指定的会议/活动策划者所支付的所有与活动相关的花费(已在合约中列出)，例如会议租用、餐饮、客房等，但不包括税费和服务费用。酒店将全权决定费用是否属于合理费用。
- 3、每次活动最多可赚取100,000点荣誉客会积分和100,000航空里程(或等值积分，取决于航空公司营销合作伙伴)。

Event Bonus Program

- 1、Members who hold qualifying events at hotels within the Hilton Worldwide portfolio outside the U.S. and Canada are eligible to receive 1 Hilton Bonus Point and 1 airline mile per US\$1 spent or 1.5 Hilton Bonus Points per US\$1 spent.
- 2、Eligible charges include all event-related spending (listed in the contract) paid for by the meeting/event planner named in this agreement, such as meeting room hire, catering, guest rooms, and excluding taxes and service charges. The hotel may decide in its sole discretion whether the charges are eligible charges.
- 3、A maximum of 100,000 Hilton Points and 100,000 airline miles (or equivalent depending on the airline Marketing Partner) can be claimed per event.

今天您就可以免费在酒店前台注册加入荣誉客会，或者登入hiltonhonors.com在线注册。

Join for free today at the front desk at any of our ten distinct hotel brands or at hiltonhonors.com.



会议设施图 | Capacity Chart

楼层	会议室名称	长*宽 (米)	总平方米	层高 (米)	剧院式	教室式	董事会式	回字型	鸡尾酒	圆桌式	U型
六楼	宴会厅	42*24	1008	7.5	900	650	146	146	900	600	126
六楼	宴会厅1+2	28*24	672	7.5	550	400	102	102	500	400	90
六楼	宴会厅3	14*24	336	7.5	300	200	80	80	300	180	72
六楼	多功能厅1	18*10	180	3.5	130	72	56	56	130	80	48
六楼	多功能厅2	9*10	90	3.5	60	40	36	36	60	40	30
六楼	多功能厅3	9*10	90	3.5	60	40	36	36	60	40	30
六楼	多功能厅4	9*10	90	3.5	60	40	36	36	60	40	30
六楼	多功能厅2+3	18*10	180	3.5	130	72	56	56	130	80	48
六楼	多功能厅2+3+4	27*10	270	3.5	180	120	78	78	180	120	72
六楼	多功能厅5	6*10	60	3.5	40	26	30	30	40	30	26
六楼	多功能厅6	9*10	90	3.5	60	36	30	30	60	40	26
六楼	贵宾厅	11*11	121	3.5	90	60	36	36	90	40	30
六楼	董事会议室	14*7	98	3.5	70	42	36	36	70	30	30
六楼	商务中心会议室	7.5*4	30	3.5	/	/	14	/	/	/	/
六楼	空中露台	20*4	80	/	50	/	/	54	50	/	/

会议设施平面图 | Floor Plan

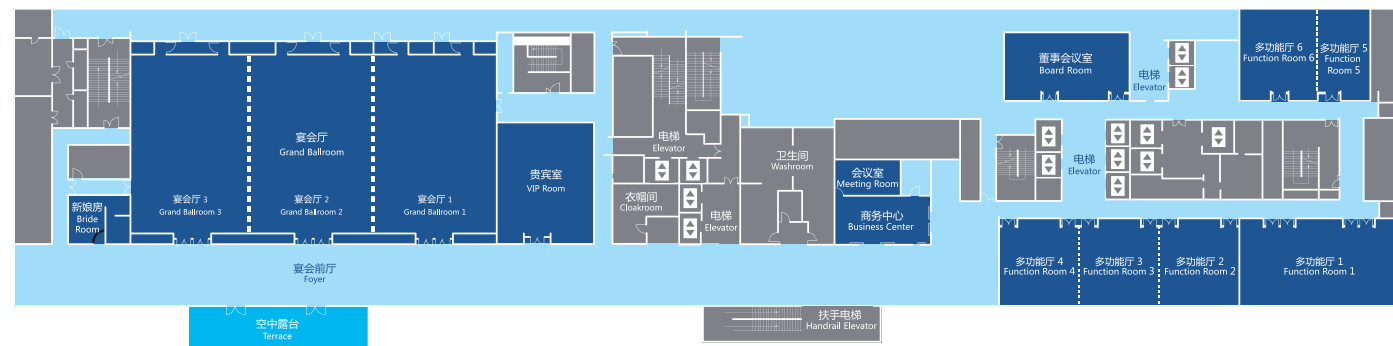

楼层	会议室名称	总平方米	层高 (米)
一楼	演播厅	2000	18

🚪 电梯
 ■ 会议室
 ■ 设施/服务
 ■ 休息区域

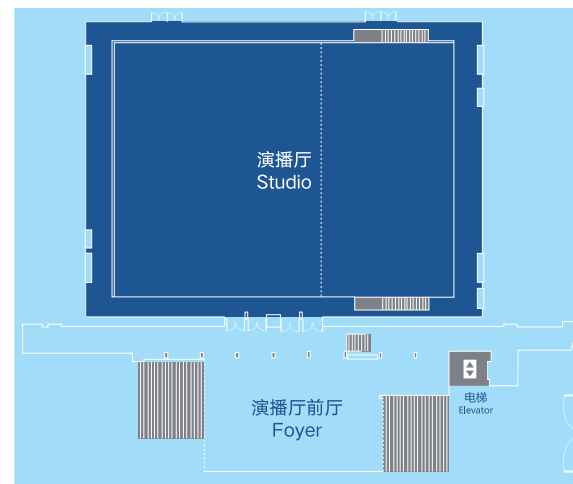

至酒店路线图 | Hotel Driving Map



上海虹桥机场至酒店路线

虹桥路—沪青平公路—外环高速—京沪高速—现代大道—南施街—苏州大道

Hongqiao Road – Huqingping Highway – Waihuan Expressway – Jinghu Expressway – Modern Avenue – Nanshi Street – Suzhou Avenue

无锡苏南硕放机场至酒店路线

机场互通—京沪高速—苏州北枢纽—沪宁高速苏州东互通—上高路辅路—上高路—娄江快速路—星湖街—苏州大道

Airport Interchange – Jinghu Expressway – North Hub of Suzhou – Huning Expfressway East of Suzhou Interchange – Shanggao Road Auxiliary Road – Shanggao Road – Loujiang Expressway – Xinghu Street – Suzhou Avenue



扫描二维码，查看酒店全景VR
Scan the QR code, explore hotel VR